



Aluminium hinges



Art.:6087



Art.:6023



Art.:6022



Art.:6848.70



Art.:158.5914



Art.:6876



Art.:6088



Art.:6872



Art.:6871



Art.:158.5314



Art.:158.5414



Art.:158.5814



Art.:158.6117



Art.:158.6117

Aluminium hinges

Aluminium piano hinge

rolled

Art.no.	Material		Dimensions in mm				
	Rod	Pin	A	B	C	D Pin Ø	E
6716.70	Aluminium	Steel	2000	20	0,6	2,4	15
6725.70	Aluminium	Steel	2000	25	0,8	2	15
6755.70	Aluminium	Aluminium	2000	35	1	3	30
6769.70	Aluminium	Aluminium	2000	40	1,2	3	20
6776.70	Aluminium	Aluminium	2040	40	1,5	6	15
6784.70	Aluminium	Aluminium	2000	50	1,2	3	20
6786.70	Aluminium	Aluminium	2000	50	1,5	4	15
6806.70	Aluminium	Aluminium	2000	60	2	6	30
6820.70	Alu 5754	Aluminium	2000	80	3	6	40

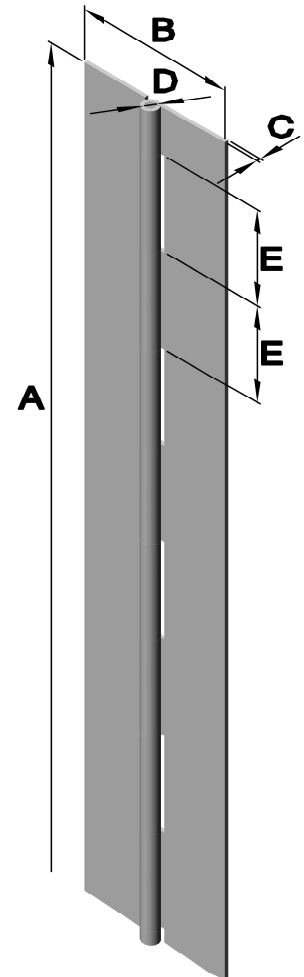

Aluminium profile hinge

Width 50

Art no.	Material		Dimensions in mm				
	Rod	Pin	A	B	C	D Pin Ø	E
6848.70	Alu 6060 T5	Stainless steel	2000	50	3	5,2	35,5

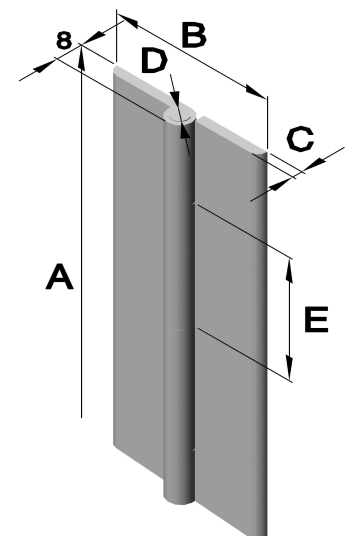

Another length/ drilling on request.

Aluminium hinges

Aluminium profile hinge

Art no.	Material		Dimensions in mm				
	Rod	Pin	A	B	C	D Pin Ø	E
6841.71	Alu 6082 T5	Stainless steel	915	31,75	1,3	2,2	12,7
6849.70	Alu 6082 T5	Stainless steel	1830	31,75	1,3	2,2	12,7
6842.70	Alu 6082 T5	Stainless steel	915	44,45	1,3	2,2	12,7
6843.71	Alu 6082 T5	Stainless steel	1830	44,45	1,3	2,2	12,7
6845.70	Alu 6082 T5	Stainless steel	915	63,5	1,3	2,2	12,7
6847.71	Alu 6082 T5	Stainless steel	1830	63,5	1,3	2,2	12,7

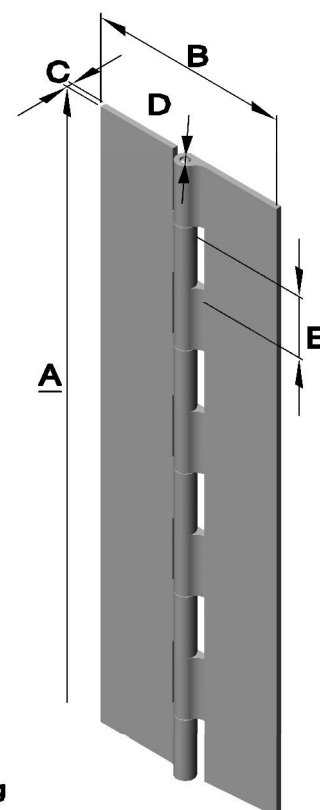

Another length/ drilling on request.

Aluminium profile hinge with double joint

Opening angle 180° (must be ordered separately)

Art no.	Material		Dimension in mm		
	Rod	Pin	A	B	D Pin Ø
6850.70	Alu 6060 T5	Stainless steel	2000	65	5
6851.70	Alu 6060 T5	Stainless steel	2500	115	5
6852.70	Alu 6060 T5	Stainless steel	3000	115	5

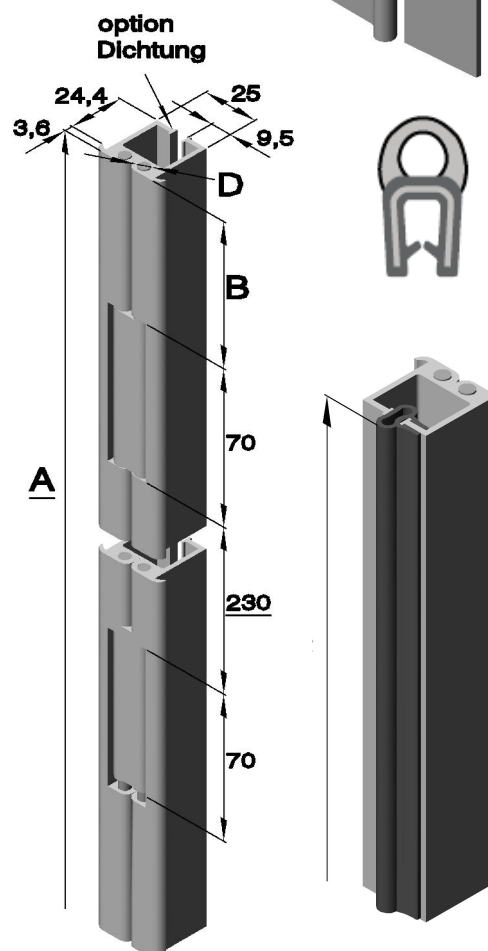

Sealing

for hinges with double joint

Art no.	Material	Dimension in mm
		A
6853.D	Rubber black	2000
6854.D	Rubber black	2500
6855.D	Rubber black	3000

Aluminium hinges

Art.Nr. 6540 (drilled and countersunk)
Cantilevered

Article no.			
Series	Execution	Material	
		Aluminium 6060 T5	
		Silver	Black
6540	.01 without plug	.70	.77
6540	.02 with plug	.70	.77

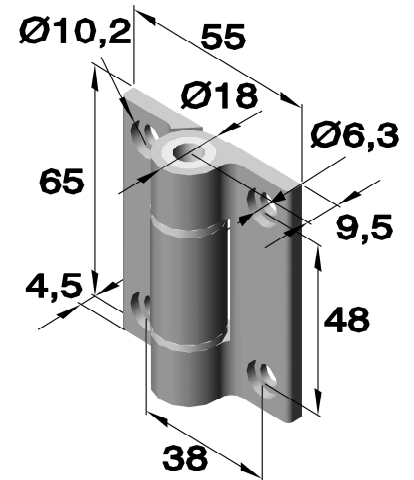

Art no.6872/6873
with integrated spring

Also available as:

Cantilever hinge see chapter "Hinges"

Torque/ detent hinge see chapter "Torque/ detent hinges"

Article no.				Spring force in Nm		
Series	Execution	Material		0°	90°	180°
		Aluminium 6060 T5				
		Silver	Black			
6872	.01 Opening	.70	.77	0,23	0,45	0,7
6872	.03 Closing	.70	.77	0,23	0,45	0,7
6872	.02 Opening	.70	.77	0,12	0,24	0,35
6872	.04 Closing	.70	.77	0,12	0,24	0,35
6873	.01 Opening	.70	.77	0,9	1,1	1,3
6873	.02 Closing	.70	.77	0,9	1,1	1,3

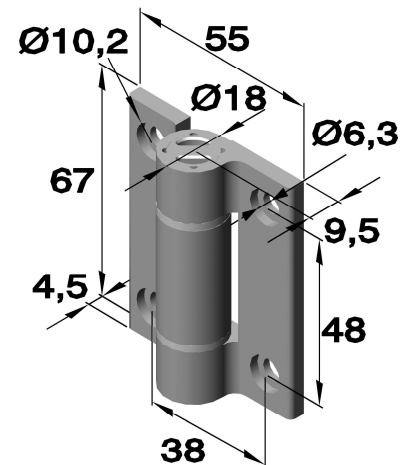

Art.no.:6874(perforated and countersunk)
Detent hinge

Detent positions all 30° from 0° to 270°.

Also available with 3 different detent moments.

Article no.			Detent moment
Series	Execution	Material	
		Black	
		Alu 6060 T5	
6874	.01	.77	1,8 Nm
6874	.02	.77	2,5 Nm
6874	.03	.77	3,2 Nm
6874	.04	.77	5,0 Nm

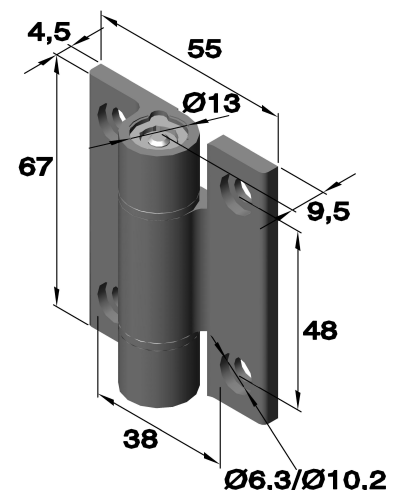

Aluminium hinges

Art.no.: **6871** (perforated and countersunk)
Torque hinge

Holding torque: 0 - 5 Nm max.
Adjusting screw: internal hex 4
Temperature stability: -20 °C - + 80 °C

Max. tensile strength: 6000 N
Max. shear strength: 5000 N

Article no.			
Series	Execution	Material	
		Colorless	Black
6871	.04	Alu 6060 T5	Alu 6060 T5
		.70	.77

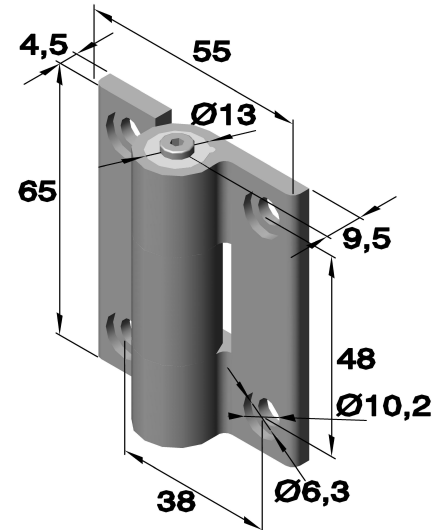

Art.no.: **6871** (perforated and countersunk)
Torque hinge

Holding torque: 0 - 5 Nm max.
Adjusting screw: internal hex 4
Temperature stability: -20 °C - + 80 °C

Max. tensile strength: 6000 N
Max. shear strength: 5000 N

Article no.			
Series	Execution	Material	
		Raw	Black
6871	.05	Alu 6060 T5	Alu 6060 T5
		.70	.77

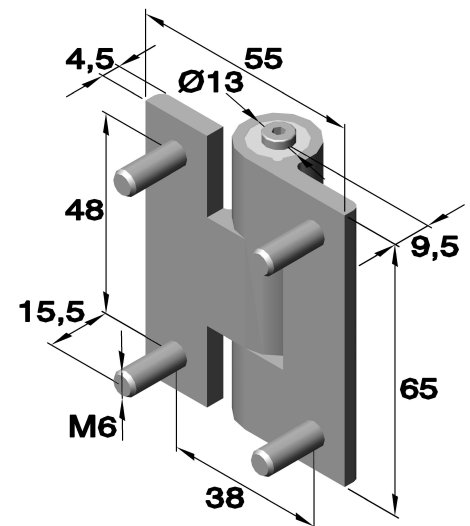

Art.no. **6088** (drilled and countersunk)
with spring and intermediate ring made of nylon

The hinge moves itself automatically back to the initial position with an opening angle of up to 80°.

Above 80° the spring function is cancelled.

The left execution (.05) is a mirror image to the right execution (.06).

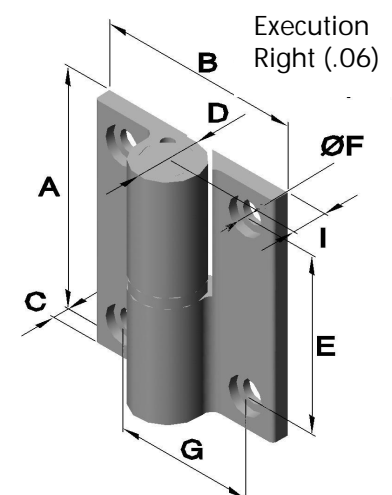

Article no.				Dimensions in mm							
Series	Execution		Material	A	B	C	D	E	Ø F	G	I
	Left	Right									
6088	.05	.06	.77 (Silver)	65	55	4,5	18	48	6,5-10,4	38	9,5
6088	.07	.08	.77 (Black)	65	55	4,5	18	48	6,5-10,4	38	9,5

Aluminium hinges

Art.no. 6876 (drilled and countersunk) Cantilevered hinge

Article no.			
Series	Execution	Material	
		Aluminium 6060 T5	
		Silver	Black
6876	.08	.71	-
6876	.09	-	.77

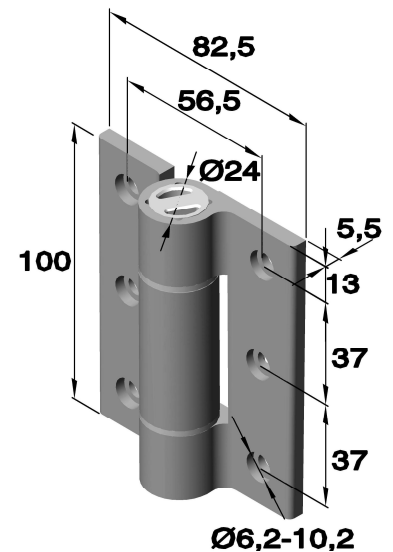

Art.no. 6876 (drilled and countersunk) with integrated spring

Article no.				Spring force in Nm		
Series	Execution	Material		0°	90°	180°
		Aluminium 6060 T5				
		Silver	Black			
6876	.01	.70	.77	2,4	3,1	3,8
6876	.02	.70	.77	2,4	3,1	3,8

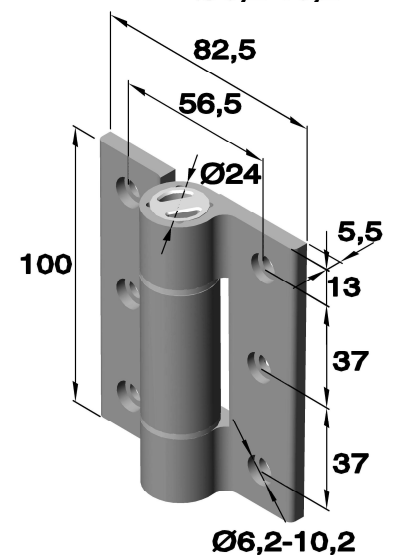

Art.no. 6876 (drilled and countersunk) Soft-closing torque hinge

Opens and closes steamed.
Function ensures to 115°
Torque per couple: 2,5 to 4,5 Nm

Article no.		
Series	Execution	Material
		Anodized colorless Aluminium 6060 T5
6876	.06	.71

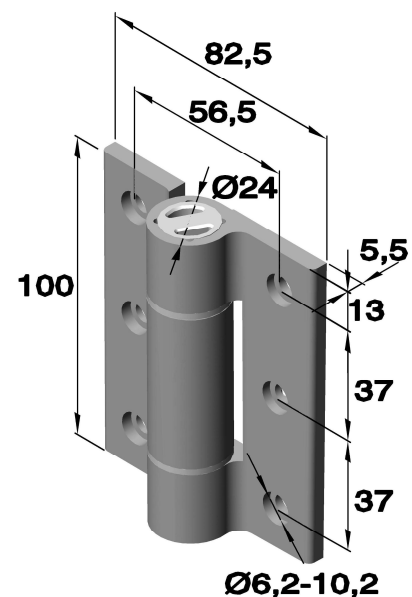

Aluminium hinges

Art no.: **6960** (perforated and countersunk)

Spring hinge

with integrated spring

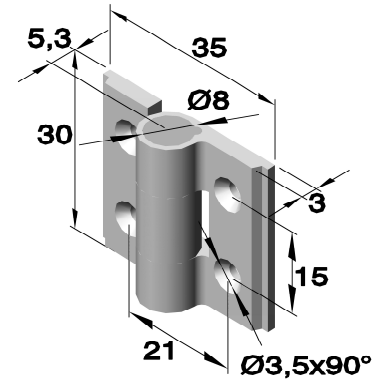

Article no.		Material		Spring force in Nm		
Series	Execution	Colorless	Black	0°	90°	180°
		Alu 6060 T5	Alu 6060 T5			
6960	.01	.71	.77	0,2	0,12	0,07

Art no.: **6871** (perforated and countersunk)

Adjusting screw: internal hex 2,5
Temperature stability: -20 °C to + 80 °C

Max. tensile strength: 2240 N
Max. shear strength: 1050 N

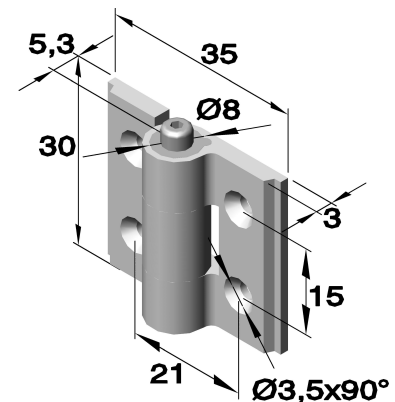

Article no.		Material		
Series	Execution	Raw	Colorless	Black
		Alu 6060 T5	Alu 6060 T5	Alu 6060 T5
6871	.01	.70	-	.77
6871	.02	-	.70	-

Art.no.: **6871** (perforated and countersunk)

Detent positions all 30° from 0° to 270°

Detent moment is not adjustable.

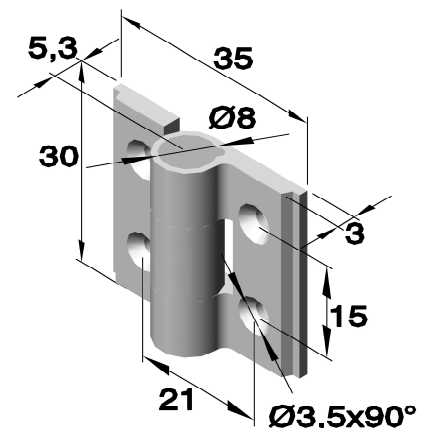

Article no.		Material	
Series	Execution	Anodized colorless	Anodized black
		Alu 6060 T5	Alu 6060 T5
6871	.06	.71	.77

Aluminium hinges

Art no. 158. 5314. __. __ (spring force adjustable)

with integrated spring

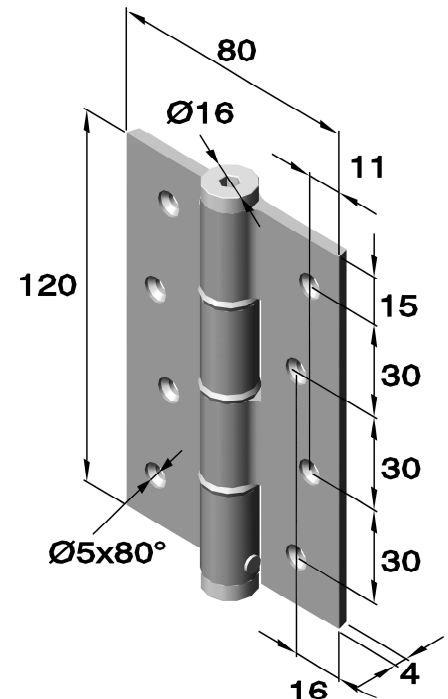
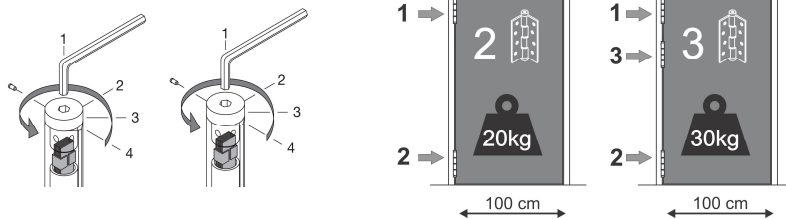

Article no.		Load in kg		
Series	Material		for 2 hinges	for 3 hinges
	Aluminium	Anodized		
158.5314.01	.71	Silver	20	30
158.5314.02	.72	Gold	20	30
158.5314.03	.73	Bronze	20	30
158.5314.06	.76	White	20	30
158.5314.09	.77	Black	20	30

This product will be delivered only in pairs.
Close doors automatically, integrated mechanic is very tough and adjustable.
Max. aperture angle 180°.

Art no. 158. 5814. __. __ (spring force adjustable)

with integrated spring

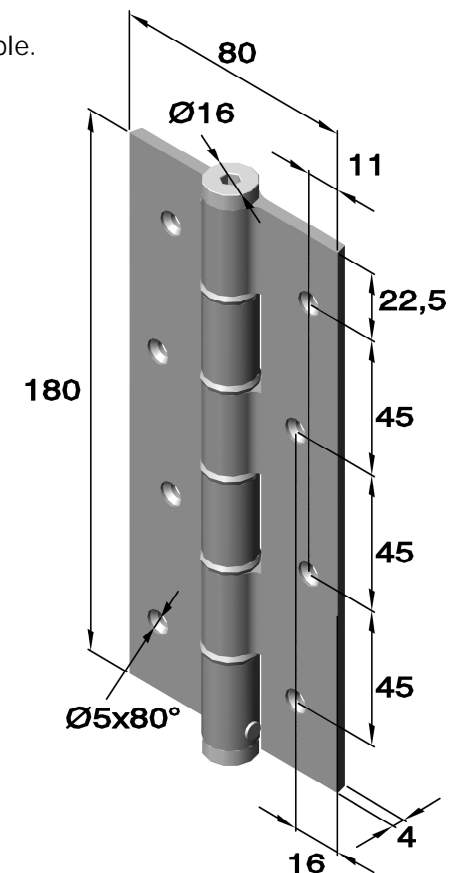
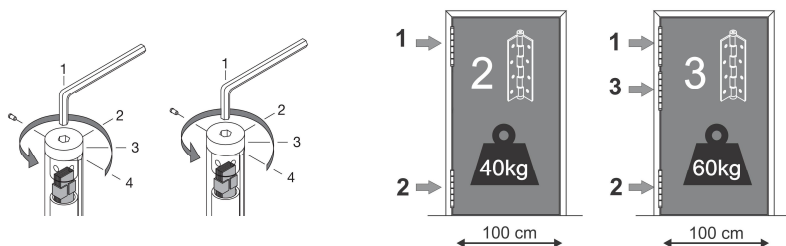

Article no.		Load in kg		
Series	Material		for 2 hinge	for 3 hinge
	Aluminium	Anodized		
158.5814.01	.71	Silver	40	60
158.5814.02	.72	Gold	40	60
158.5814.03	.73	Bronze	40	60
158.5814.06	.76	White	40	60
158.5814.09	.77	Black	40	60

This product will be delivered only in pairs.
Close doors automatically, integrated mechanic is very tough and adjustable.
Max. aperture angle 180°.

Aluminium hinges

Art no. 158. 5414. __. __ (spring force adjustable)

Double joint hinge/swing door hinge
with integrated spring

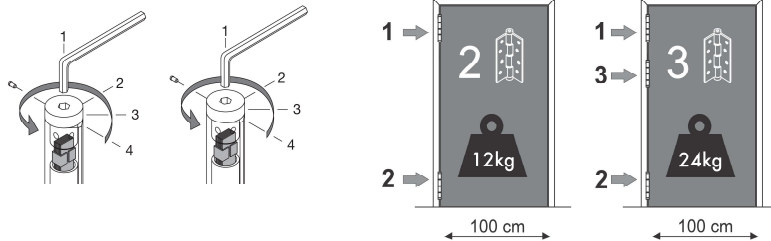

Article no.		Load in kg		
Series	Material		for 2 hinge	for 3 hinge
	Aluminium	Anodized		
158.5414.01	.71	Silver	12	24
158.5414.02	.72	Gold	12	24
158.5414.03	.73	Bronze	12	24
158.5414.06	.76	White	12	24
158.5414.09	.77	Black	12	24

This product will be delivered only in pairs.

Close doors automatically, integrated mechanic is very tough and adjustable.
Max. aperture angle 180°.

Art no. 158. 5914. __. __ (spring force adjustable)

double joint hinge/swing door hinge
with integrated spring

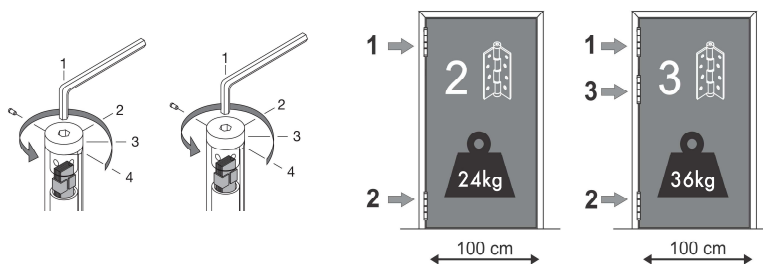

Article no.		Load in kg		
Series	Material		for 2 hinge	for 3 hinge
	Aluminium	Anodized		
158.5914.01	.71	Silver	24	36
158.5914.02	.72	Gold	24	36
158.5914.03	.73	Bronze	24	36
158.5914.06	.76	White	24	36
158.5914.09	.77	Black	24	36

This product will be delivered only in pairs.

Close doors automatically, integrated mechanic is very tough and adjustable.
Max. aperture angle 180°.

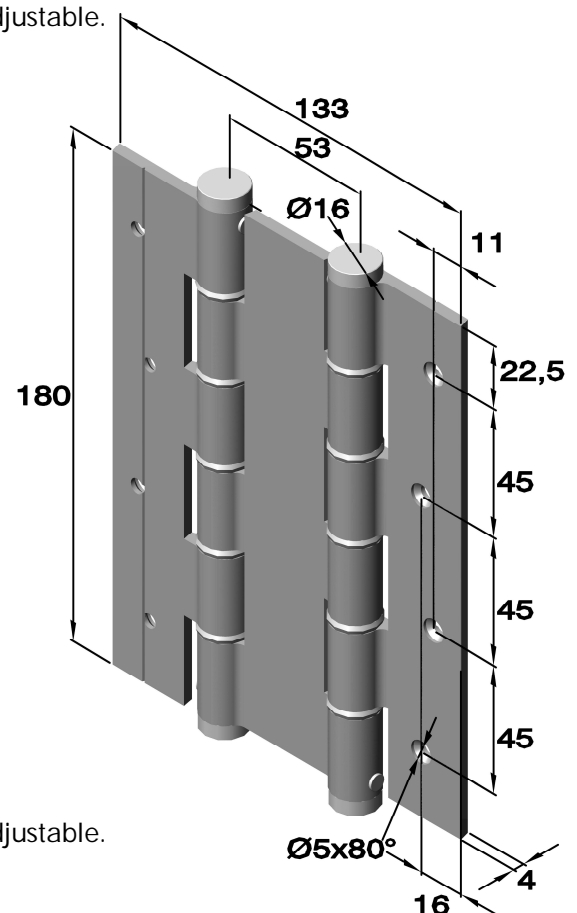
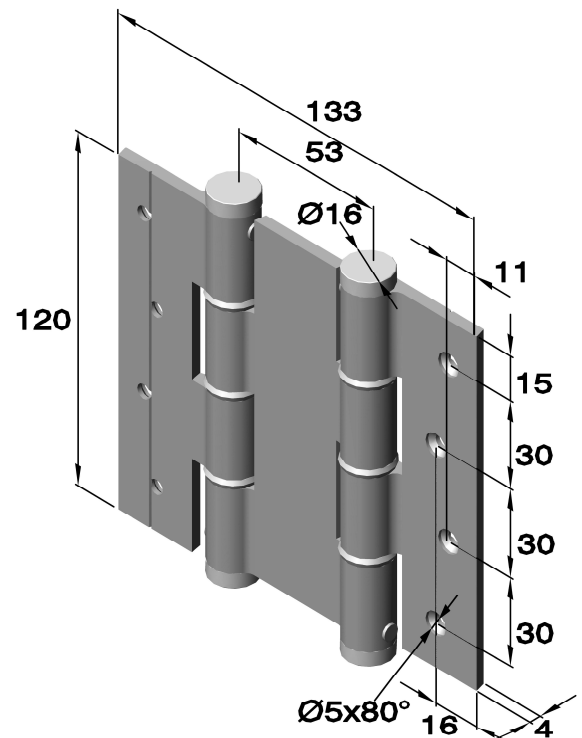

Aluminium hinges

Art no. 158. 6314. __. __ (spring force adjustable)

with integrated spring

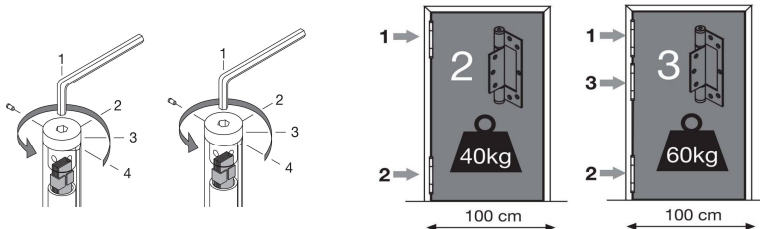

Article no.			Load in kg	
Series	Material		for 2 hinge	for 3 hinge
	Aluminium	Anodized		
158.6314.01	.71	Silver	40	60
158.6314.02	.72	Gold	40	60
158.6314.03	.73	Bronze	40	60
158.6314.06	.76	White	40	60
158.6314.09	.77	Black	40	60

This product will be delivered.
Close doors automatically, integrated mechanic is very tough and adjustable.
Max. aperuture angle 180°.

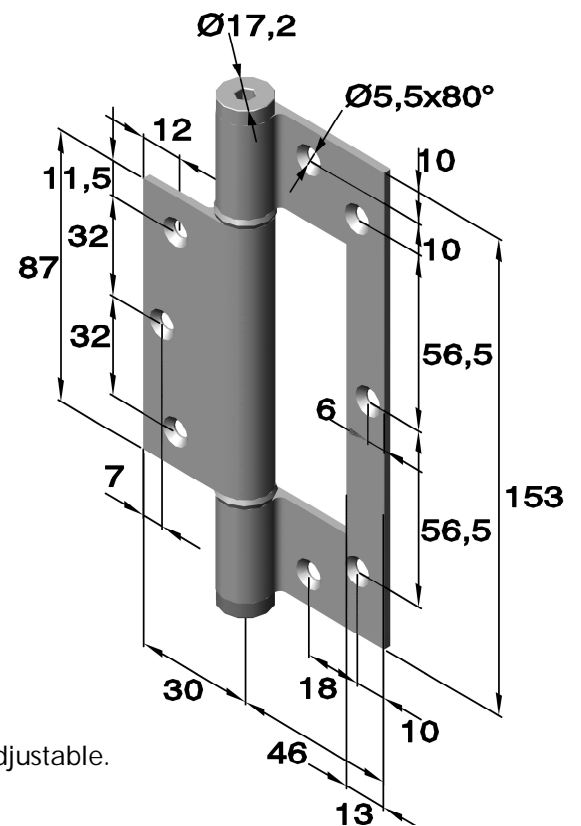

Art no. 158. 6717. __. __ (spring force adjustable)

with integrated spring

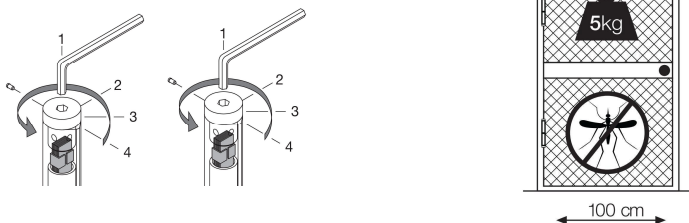

Article no.		
Series	Material	
	Aluminium	Anodized
158.6717.01	.71	Silver
158.6717.02	.72	Gold
158.6717.03	.73	Bronze
158.6717.06	.76	White
158.6717.09	.77	Black

This product will be delivered only in pairs.
Close doors automatically, integrated mechanic is very tough adjustable.
Max. aperuture angle 180°.

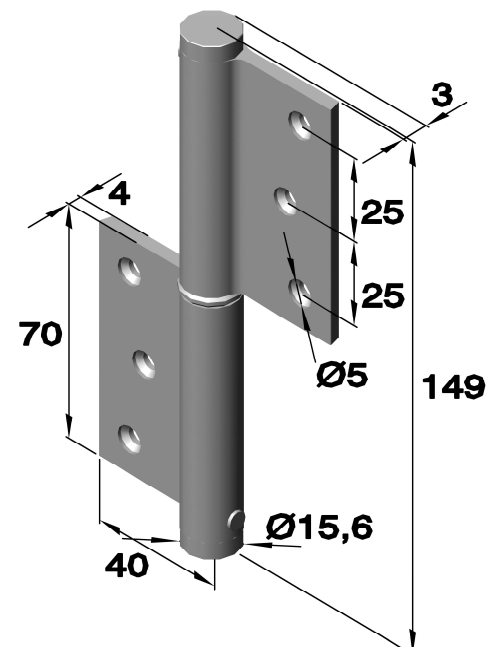

Aluminium hinges

Art.no: 6085 (perforated and countersunk)
with fixed, Zinc plated steel bolt and nylon coating

Pin diameter 8mm.

Article no.			
Series	Execution		Material
	Left	Right	Aluminium
6085	.01	.02	Anodized
			.70

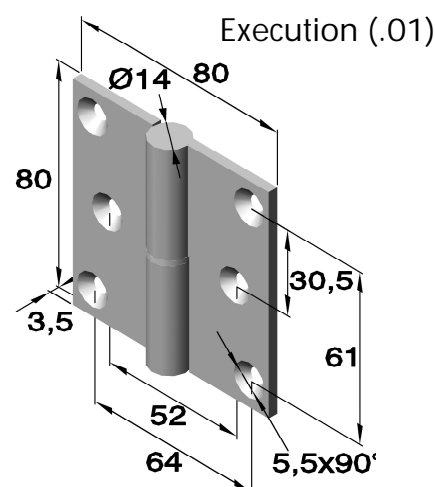

Art.no: 6086 (perforated and countersunk)
with fixed, Zinc plated steel bolt and nylon coating

Pin diameter 8mm.

Article no.			
Series	Execution		Material
	Left	Right	Aluminium
6086	.01	.02	Anodized
			.70

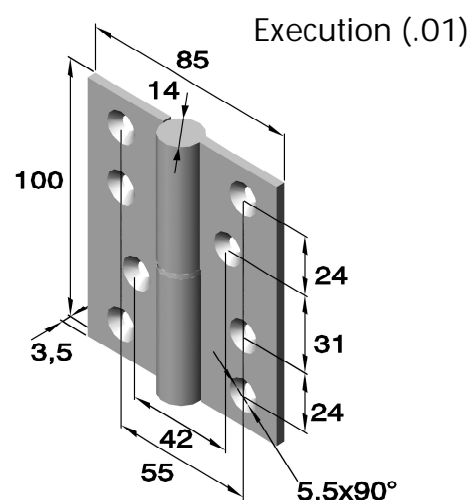

Art.no: 6087 (perforated and countersunk)
with fixed, Zinc plated steel bolt and nylon coating

Pin diameter 9mm.

Article no.			
Series	Execution		Material
	Left	Right	Aluminium
6087	.01	.02	Anodized
			.70

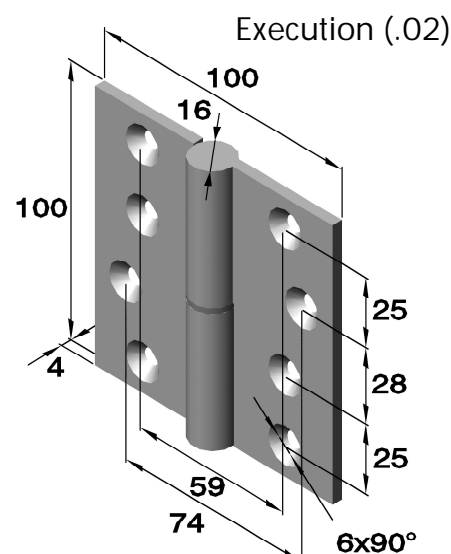

Aluminium hinges

Weld on hinge-rolls „ABR “ with round ends

FVS with fixed stainless-steel pin and brass intermediate ring.

AVS with extractable stainless-steel pin and brass intermediate ring.

Article no.				Dimensions in mm				
Series	L	Execution		Material	D	B	d	Load capacity ca. in kg
		FVS	AVS	Aluminium				
ABR	60	FVS	AVS	.70	10	12	6	50
ABR	80	FVS	AVS	.70	13	16	8	70
ABR	100	FVS	-	.70	16	20	10	100
ABR	120	FVS	AVS	.70	16	20	10	120
ABR	150	FVS	-	.70	20	25,5	13	150
ABR	180	FVS	-	.70	20	25,5	13	170

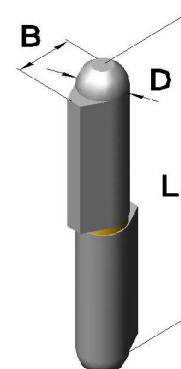

Art.no.:6022

with riveted stainless-steel pin; drilling on request

Article no.			Dimension in mm										
Series	Execution	Material	L	B	C Ø	D	E	F	f	G	S	Pin Ø	
		Raw											
		Aluminium											
6022	.01	.70	32	50	-	8	4	-	-	-	3	5,2	
6022	.02	.70	50	50	-	8	4	-	-	-	3	5,2	
6022	.03	.70	32	50	3,2	8	4	30	-	20	3	5,2	

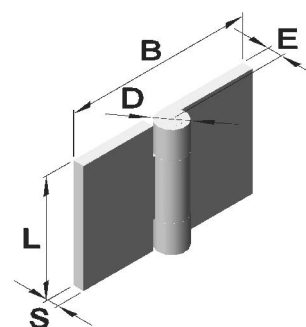

Art.no.:6023

with riveted stainless-steel pin; drilling on request

Article no.			Dimension in mm					
Series	Execution	Material	L	B	D	E	S	Pin Ø
		Raw						
		Aluminium						
6023	.01	.70	32	50	8	4	3	5,2
6023	.02	.70	50	50	8	4	3	5,2

