

## Gummi-Metall-Puffer

Gummi-Metall-Puffer, Typ "D"  
mit Gewindebolzen, einseitig

Naturkautschuk in 55° shore -"mittel"  
Auf Anfrage auch in 45°, 65°, 70° Shore

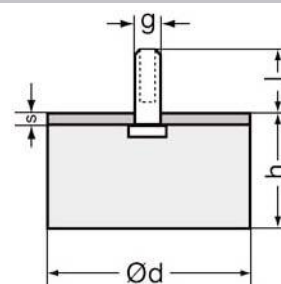

| Artikel Nr.   | Abmessungen in mm |     |    |    |     |
|---------------|-------------------|-----|----|----|-----|
|               | Ø d               | h   | g  | L  | S   |
| H-04-01008    | 10                | 8   | M4 | 11 | 2   |
| H-04-01010    | 10                | 10  | M4 | 11 | 2   |
| H-04-01015    | 10                | 15  | M4 | 11 | 2   |
|               |                   |     |    |    |     |
| H-04-01310    | 13                | 10  | M4 | 11 | 2   |
|               |                   |     |    |    |     |
| H-04-01415    | 14                | 15  | M4 | 11 | 2   |
|               |                   |     |    |    |     |
| H-04-01504    | 15                | 4   | M4 | 11 | 2   |
| H-04-01506    | 15                | 6   | M4 | 11 | 2   |
| H-04-01507    | 15                | 7   | M4 | 11 | 2   |
| H-04-01508    | 15                | 8   | M4 | 11 | 2   |
| H-04-01510    | 15                | 10  | M4 | 11 | 2   |
| H-04-01512    | 15                | 12  | M4 | 11 | 2   |
| H-04-01513    | 15                | 13  | M4 | 11 | 2   |
| H-04-01515    | 15                | 15  | M4 | 11 | 2   |
| H-04-01520    | 15                | 20  | M4 | 11 | 2   |
| H-04-01525    | 15                | 25  | M4 | 11 | 2   |
| H-04-01528    | 15                | 28  | M4 | 11 | 2   |
| H-04-01530    | 15                | 30  | M4 | 11 | 2   |
|               |                   |     |    |    |     |
| H-04-001805,5 | 18                | 5,5 | M6 | 18 | 2   |
| H-04-001807,5 | 18                | 7,5 | M6 | 18 | 2   |
| H-04-001808,5 | 18                | 8,5 | M6 | 18 | 2   |
|               |                   |     |    |    |     |
| H-04-02005    | 20                | 5   | M6 | 18 | 2,5 |
| H-04-02008    | 20                | 8   | M6 | 18 | 2,5 |
| H-04-02010    | 20                | 10  | M6 | 18 | 2,5 |
| H-04-02012    | 20                | 12  | M6 | 18 | 2,5 |
| H-04-02015    | 20                | 15  | M6 | 18 | 2,5 |
| H-04-02020    | 20                | 20  | M6 | 18 | 2,5 |
| H-04-02025    | 20                | 25  | M6 | 18 | 2,5 |
| H-04-02030    | 20                | 30  | M6 | 18 | 2,5 |
| H-04-02035    | 20                | 35  | M6 | 18 | 2,5 |
| H-04-02065    | 20                | 60  | M6 | 18 | 2,5 |
|               |                   |     |    |    |     |
| H-04-02506    | 25                | 6   | M6 | 18 | 2,5 |
| H-04-02508    | 25                | 8   | M6 | 18 | 2,5 |
| H-04-02510    | 25                | 10  | M6 | 18 | 2,5 |
| H-04-02512    | 25                | 12  | M6 | 18 | 2,5 |

| Artikel Nr.    | Abmessungen in mm |    |     |    |     |
|----------------|-------------------|----|-----|----|-----|
|                | Ø d               | h  | g   | l  | S   |
| H-04-02515     | 25                | 15 | M6  | 18 | 2,5 |
| H-04-02517     | 25                | 17 | M6  | 18 | 2,5 |
| H-04-02520     | 25                | 20 | M6  | 18 | 2,5 |
| H-04-02525     | 25                | 25 | M6  | 18 | 2,5 |
| H-04-02528     | 25                | 28 | M6  | 18 | 2,5 |
| H-04-02530     | 25                | 30 | M6  | 18 | 2,5 |
| H-04-02540     | 25                | 40 | M6  | 18 | 2,5 |
| H-04-02570     | 25                | 70 | M6  | 18 | 2,5 |
|                |                   |    |     |    |     |
| H-04-03005     | 30                | 5  | M8  | 23 | 2,5 |
| H-04-03008     | 30                | 8  | M8  | 23 | 2,5 |
| H-04-03010     | 30                | 10 | M8  | 23 | 2,5 |
| H-04-03015     | 30                | 15 | M8  | 23 | 2,5 |
| H-04-03017     | 30                | 17 | M8  | 23 | 2,5 |
| H-04-03020     | 30                | 20 | M8  | 23 | 2,5 |
| H-04-03025     | 30                | 25 | M8  | 23 | 2,5 |
| H-04-03030     | 30                | 30 | M8  | 23 | 2,5 |
| H-04-03040     | 30                | 40 | M8  | 23 | 2,5 |
| H-04-03080     | 30                | 80 | M8  | 23 | 2,5 |
|                |                   |    |     |    |     |
| H-04-03520     | 35                | 20 | M8  | 23 | 2,5 |
| H-04-03530     | 35                | 30 | M8  | 23 | 2,5 |
|                |                   |    |     |    |     |
|                |                   |    |     |    |     |
| H-04-04010     | 40                | 10 | M8  | 23 | 2,5 |
| H-04-04012     | 40                | 12 | M8  | 23 | 2,5 |
| H-04-04015     | 40                | 15 | M8  | 23 | 2,5 |
| H-04-04020     | 40                | 20 | M8  | 23 | 2,5 |
| H-04-04025     | 40                | 25 | M8  | 23 | 2,5 |
| H-04-04027     | 40                | 27 | M8  | 23 | 2,5 |
| H-04-04028     | 40                | 28 | M8  | 23 | 2,5 |
| H-04-04030     | 40                | 30 | M8  | 23 | 2,5 |
| H-04-04030-M10 | 40                | 30 | M10 | 28 | 2,5 |